

## Restoration Hessischer Landtag

Owner: Land Hessen

Architectu Waechter + Wachter, Darmstadt

Structural Eng.: Ruffert und Partner, Limburg

Approving Eng.: Stöffler-Abraham-Neujahr,  
Darmstadt

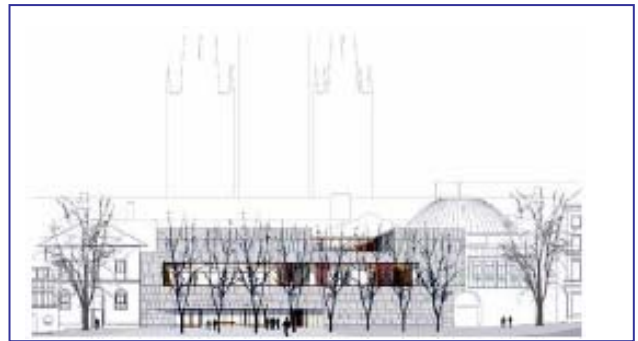

## Execution details

Product: CBCM

Surface: ~ 2000 m<sup>2</sup>

Max. span: 17 m

Slab thickness: 40, 45, 50 cm

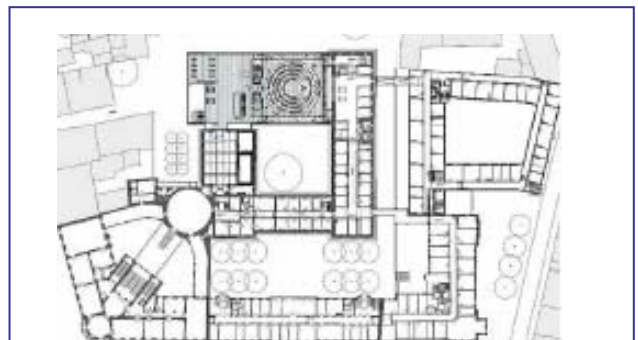

## Benefits

Application reason: load reduction  
span, improved  
natural frequency

Concrete reduction (total): 70 m<sup>3</sup>

Load reduction (total): 175 t

Reduction of CO<sub>2</sub> emissions: 15 t



## Special features

Application of post tensioned semi-precast elements in some areas

Partly application of insitu solution



## Contractor

Adam Hörnig Baugesellschaft, Aschaffenburg

## Year of completion

2006

